

**CONTENT**

ITEM	QUANTITY	DESCRIPTION	TOOLS NEEDED
1	2	FRONT MOUNT BRACKET	17MM SOCKET
2	2	CENTER MOUNT BRACKET	13MM SOCKET
3	2	REAR MOUNT BRACKET	RATCHET
4	12	M10 HEX HEAD BOLT	TORQUE WRENCH
5	12	M10 SPLIT LOCK WASHER	
6	12	M10 FLAT WASHER	
7	12	M8 SQUARE HEAD BOLT	
8	12	M8 FLAT WASHER	
9	12	M8 NYLON LOCK NUT	

**ANTI-SEIZE LUBRICANT MUST BE USED ON ALL STAINLESS STEEL FASTENERS TO PREVENT THREAD DAMAGE AND GALLING**

FRONT MOUNT BRACKET

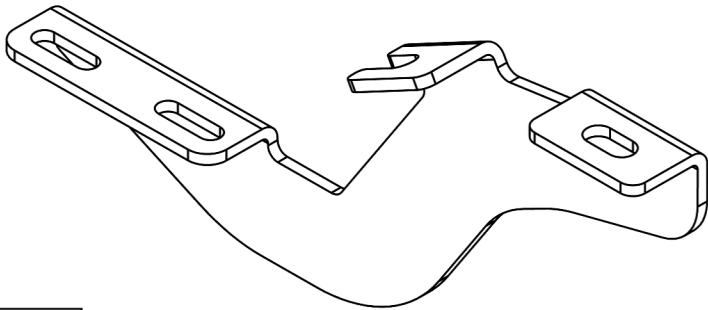

ITEM 1

CENTER MOUNT BRACKET

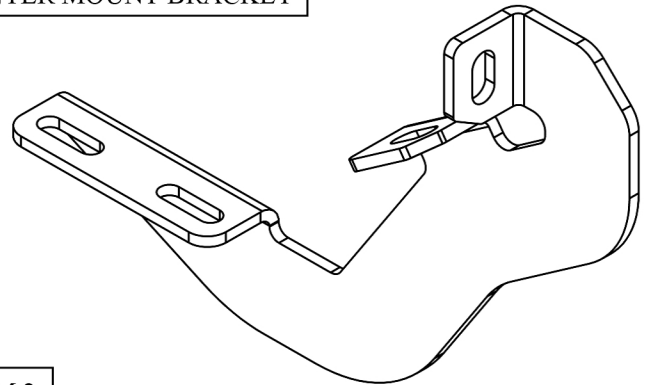

ITEM 2

REAR MOUNT BRACKET

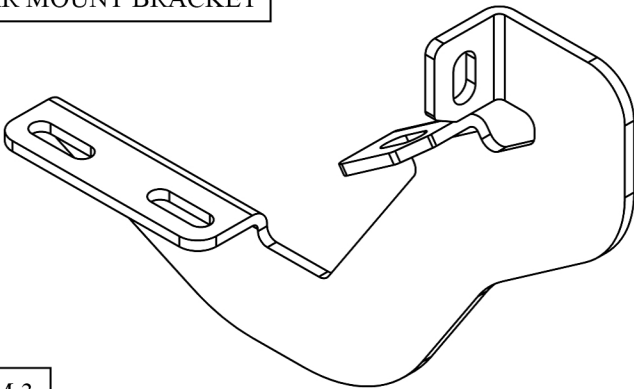

ITEM 3

## PROCEDURE

1. Remove contents from box, verify if all parts listed are present and free from damage.  
Carefully read and understand all instructions before attempting installation.

**Failure to identify damage before installation could lead to a rejection of any claim.**

2. Beginning on the driver side of the vehicle, remove (2) M10 OEM bolts from each mounting location on the rocker panel.  
See **Figure 1**.

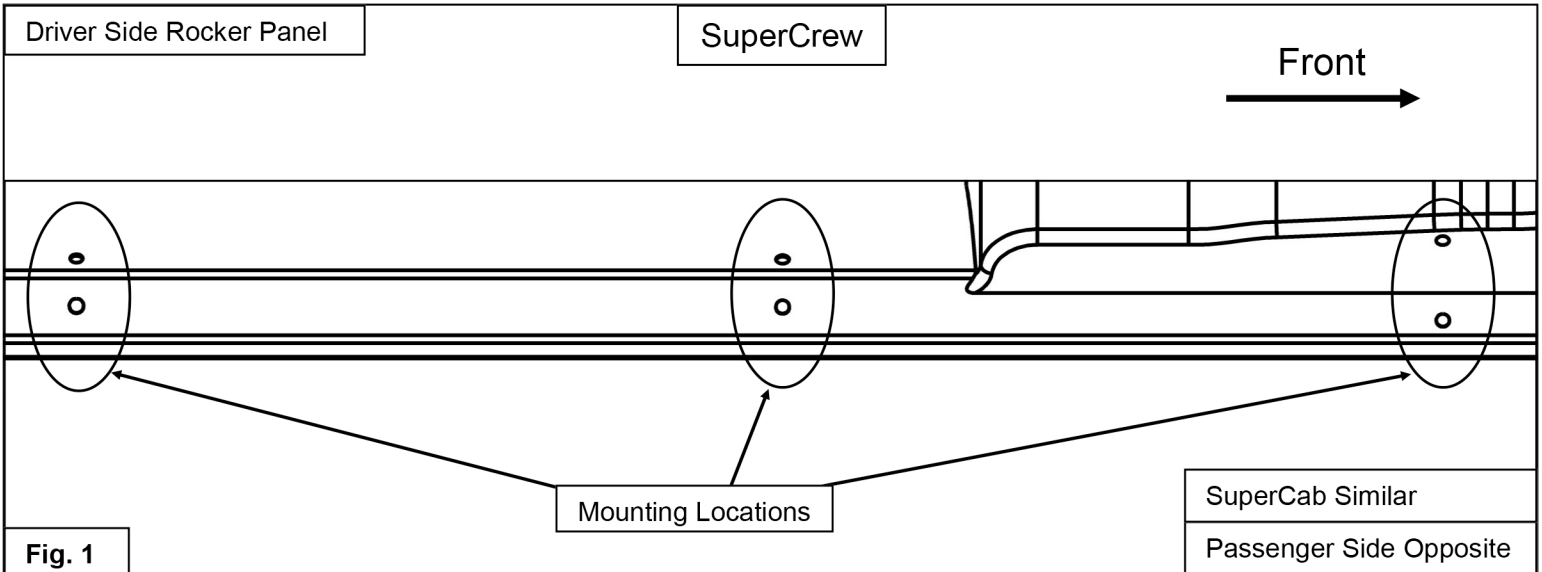

3. Loosely secure (1) Front Mount Bracket (item 1) to the rocker panel using the supplied M10 hardware (items 4-6). See **Figures 1 & 2**.

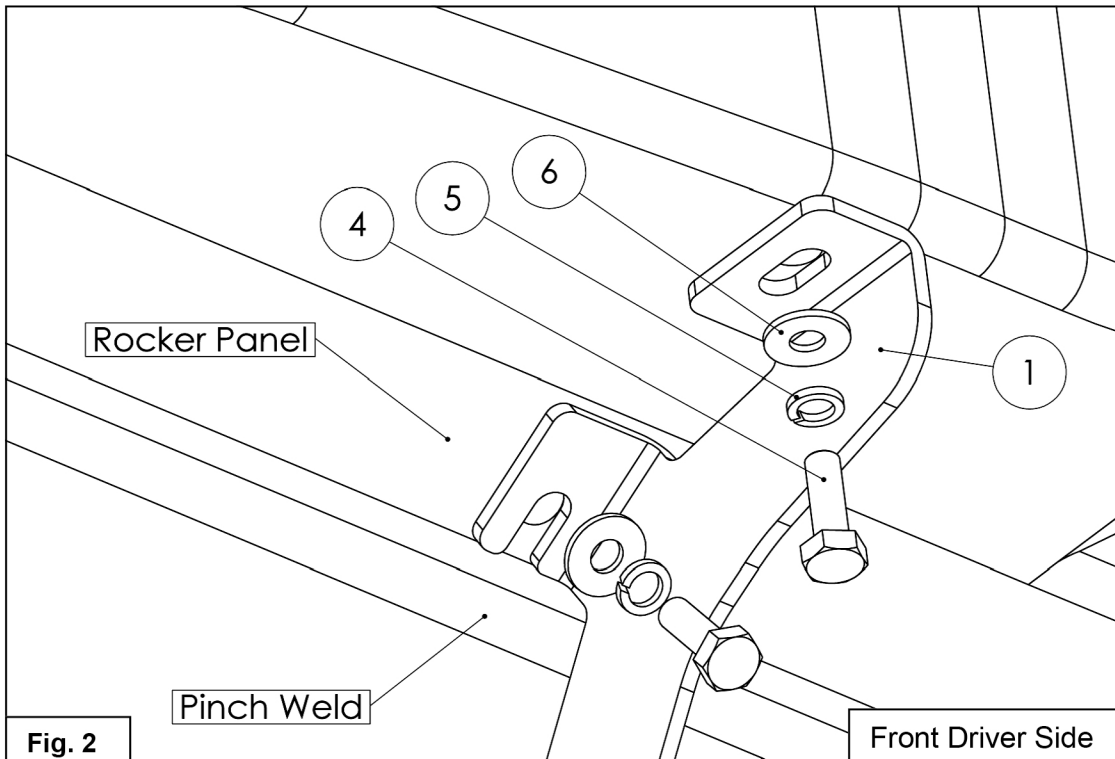

4. Loosely secure (1) Center Mount Bracket (item 2) and (1) Rear Mount Bracket (item 3) to the rocker panel using the supplied M10 hardware (items 4-6). See **Figures 3 & 4**.

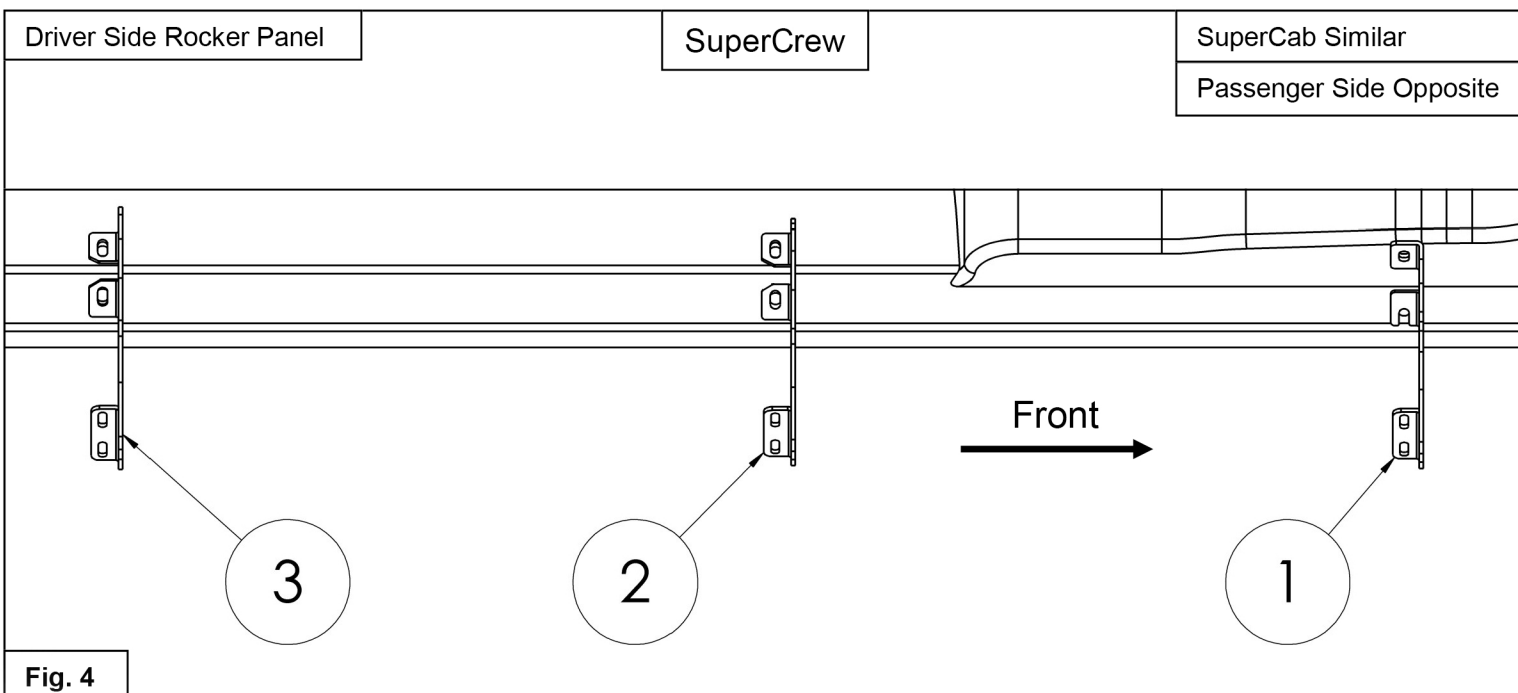
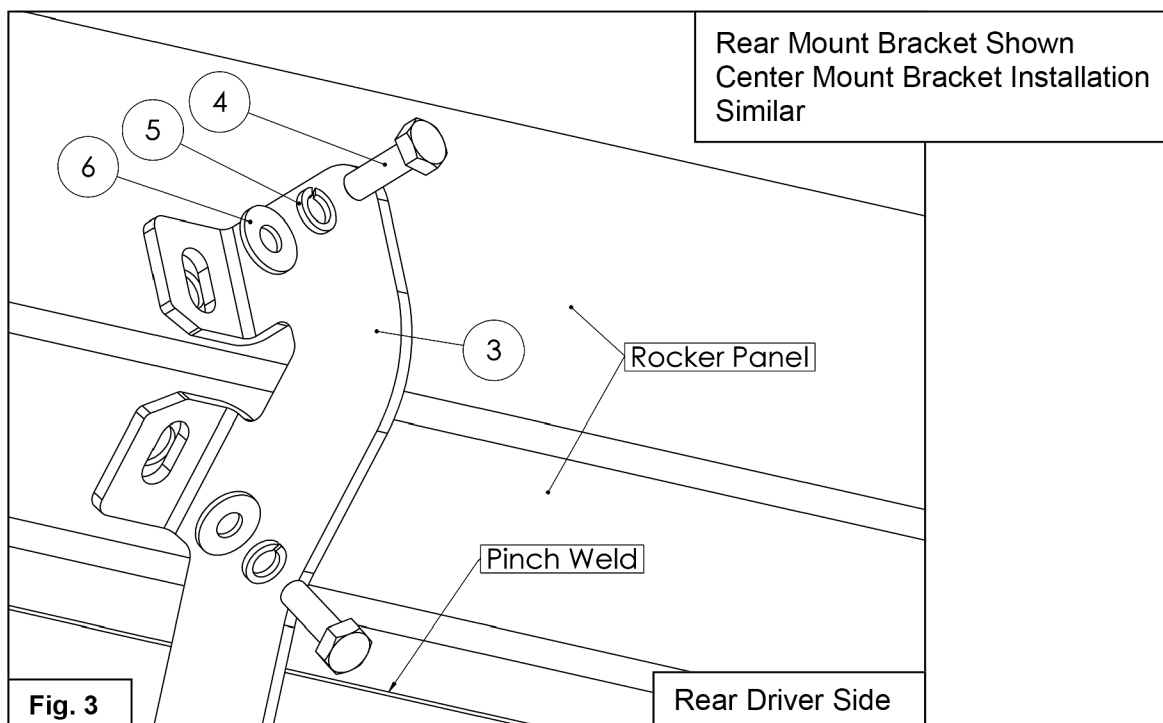

5. Move to the passenger side of the vehicle and repeat **Steps 2-4**.
6. Fasten running boards respectively to either side using the 5/16" hardware provided with the step bars (items 7-9) .  
**See Figure 5.**  
*Note 1: Running boards sold separately.*  
*Note 2: For Grate Steps Running Boards, refer to the installation instructions included with the running boards.*
7. Align and adjust the running boards and brackets as needed and fully tighten all hardware. Torque all 5/16" fasteners to 15-18 ft-lbs, and all M10 fasteners to 30-35 ft-lbs.

Figure for Sure-Grip & SG6 Running Boards

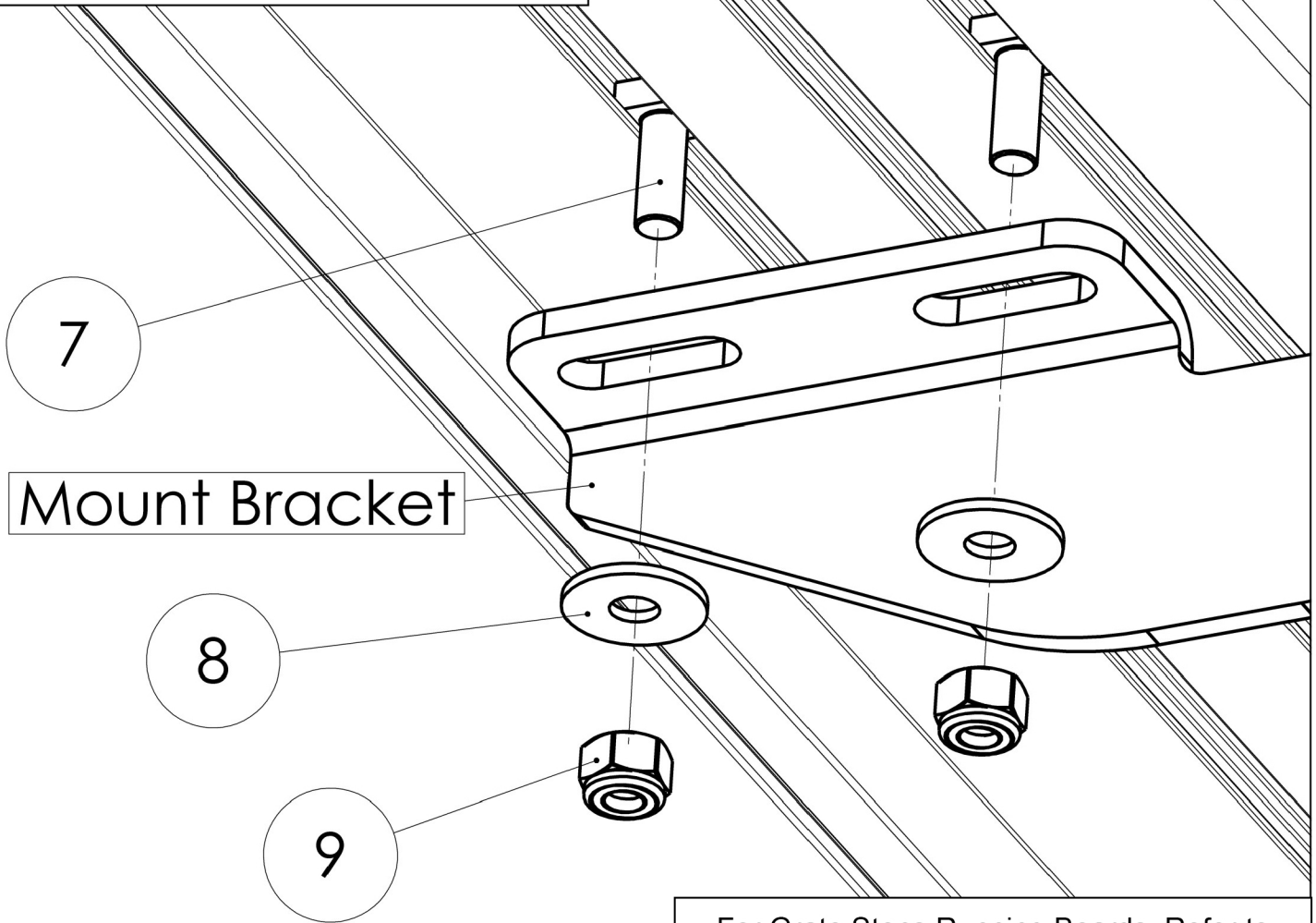

For Grate Steps Running Boards, Refer to Instructions Included with Running Boards

Fig. 5

**CARE INSTRUCTIONS**

- REGULAR WAXING IS RECOMMENDED. DO NOT USE ANY TYPE OF POLISH OR WAX THAT MAY CONTAIN ABRASIVES.
- STAINLESS STEEL PRODUCTS CAN BE CLEANED WITH MILD SOAP AND WATER. STAINLESS STEEL POLISH SHOULD BE USED TO POLISH SMALL SCRATCHES.
- GLOSS BLACK FINISHES SHOULD BE CLEANED WITH MILD SOAP AND WATER



 **BROADFEET**